

# Installation Guide

---

## Horus E2 Series

Version: 1.0

# About the Device Installation

Please refer to the following recommendations for installation.

## Installation Environment



INSTALL INDOORS  
ONLY



AVOID INSTALLATION  
NEAR  
GLASS WINDOWS



AVOID DIRECT  
SUNLIGHT  
AND EXPOSURE



AVOID USE OF ANY  
HEAT SOURCE  
NEAR THE DEVICE

## Install on the wall

- ① Attach the mounting template sticker to the wall, and drill holes according to the mounting paper.
- ② Fix the backplate on the wall with the wall mounting screws.
- ③ After passing the wires through the wiring hole and connecting them to the device, and then snap the device onto the backplate and push it down into place.
- ④ Fasten the device to the backplate with two security screws.

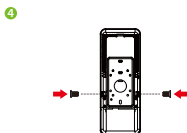
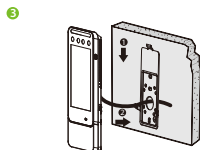
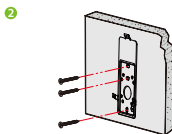
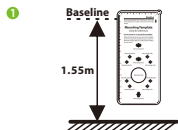



# Terminal Block

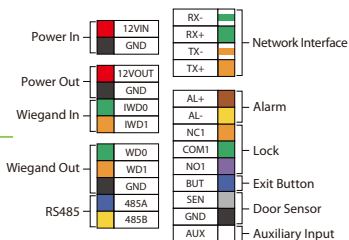
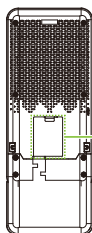

# Ethernet Connection

Establish the connection between the device and the software using an Ethernet cable. An illustrative example is provided below:

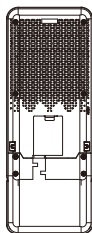

Default IP address: 192.168.1.201  
Subnet mask: 255.255.255.0

IP address: 192.168.1.130  
Subnet mask: 255.255.255.0

Tap on to enter the main menu. And then click on [Comm.] > [Ethernet] > [IP Address] to input the IP address.

**Note:** In LAN, IP addresses of the server (PC) and the device must be in the same network segment when connecting to the software.

## Power Connection

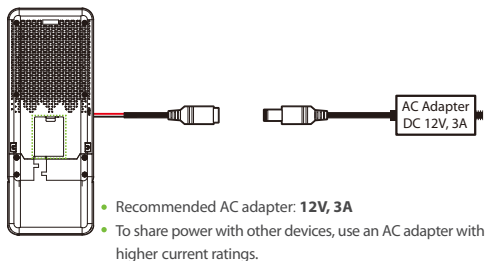

## Exit Button, Door Sensor & Auxiliary Connection

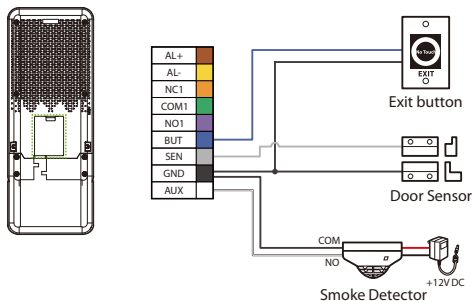

## Alarm & RS485 Reader Connection

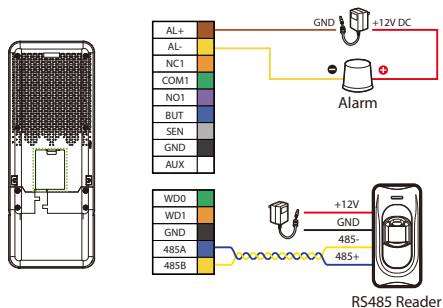

## Wiegand Reader & Access Control Connection

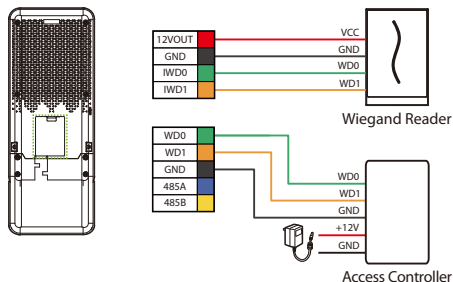

# Lock Relay Connection

The system supports both **Normally Opened Lock** and **Normally Closed Lock**. The **NO LOCK** (normally opened at power on) is connected with 'NO' and 'COM' terminals, and the **NC LOCK** (normally closed at power on) is connected with 'NC' and 'COM' terminals. Take NC Lock as an example below:

1) Device not sharing power with the lock

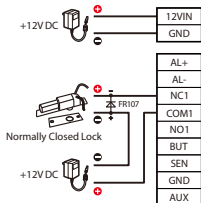

2) Device sharing power with the lock

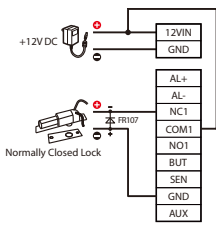

## Download Center

Scan the QR Code to download the **User Manual**, **Installation Guide** and **Quick Start Guide**.



ZKTeco Industrial Park, No. 32, Industrial Road,  
Tangxia Town, Dongguan, China.

Phone : +86 769 - 82109991

Fax : +86 755 - 89602394

[www.zkteco.com](http://www.zkteco.com)

