

ProFace X

Outdoor & Vandal-resistant Facial Recognition Terminal

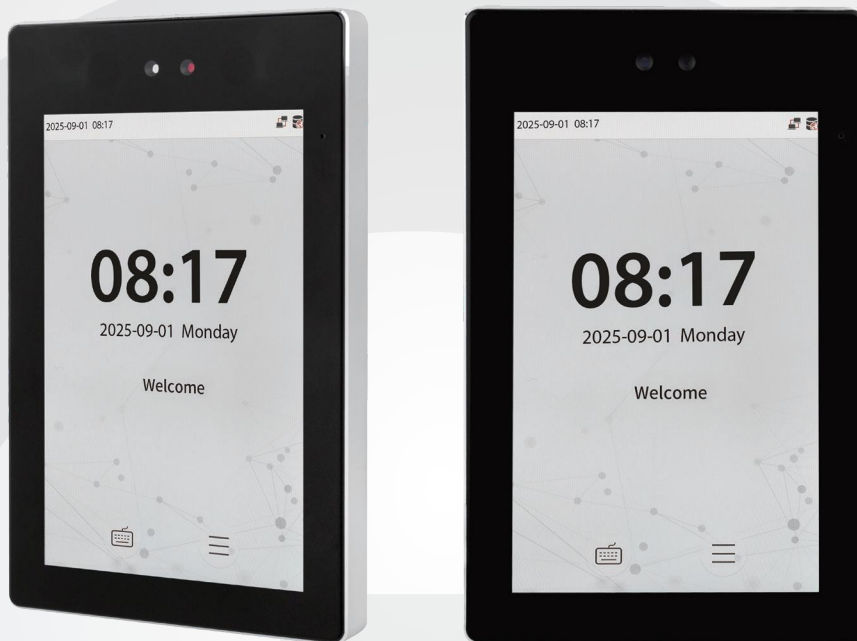

ProFace X is a fully upgraded version of the ProFace product line, which is designed to deal with all kinds of scenarios. It's powered by the latest ZKTeco-customized CPU for running the intellectualized engineering facial recognition algorithm to boost up the performance in all aspects.

With its powerful core and the latest facial recognition algorithm, the ProFace X facial recognition capability has reached a new height in the biometrics industry with a maximum of 100,000 facial templates, facial recognition speed less than 0.09 sec per face, ultimate anti-spoof ability against almost all types of fake photos and videos attack.

Other than the powerful core, ProFace X is also equipped with the latest face capture system, which enables the terminal to recognize faces under extreme strong light conditions (50,000 lux), and a microwave detector to precisely evaluate the distance between the user and the device for waking up the terminal.

ProFace X comes with a robust design that can work in extreme weather conditions from -30°C to 60°C (-22°F to 140°F); The IP68 dust and waterproof standard and IK04 protection standard also enhance its outdoor durability.

ProFace X integrates with the ONVIF video protocol to connect to the ONVIF NVR for video surveillance and recording. Moreover, ProFace X supports SIP Protocol connect to the indoor unit.

Features

- Ultra-large capacity of facial templates; 1:N - 30,000 facial templates (standard), maximum 1:N - 100,000 facial templates (optional)
 - Rapid facial recognition within 0.09s
 - Anti-spoofing algorithm against print attack (laser, color and B/W photos), videos attack, and 3D mask attack
 - Intelligent energy-saving design, precisely evaluates the distance up to 2.5m (8.2ft) between the user and the device by a microwave detector before waking up the recognition terminal
 - Integrated multiple RFID modules
 - 2MP starlight CMOS sensor camera with WDR function, which enables the terminal to recognize faces under extreme lighting conditions (0.5 lux – 50,000 lux)
- Video intercom: ZKTeco private protocol via TCP/IP & standard SIP protocol (optional)
- ONVIF Protocol (Optional)
- Dynamic QR code with ZKBio Zexus Mobile APP
 - 8" touch screen with 400 lux, which offers high visibility under strong and direct light
 - Multiple communication methods: TCP/IP, RS485, RS232, Wi-Fi (optional)
 - IP68 dust-proof and waterproof standard and IK04 protection standard
 - Wide range of working temperature (-30 ~ 60°C; -22 ~ 140°F)

Specifications (G: GL Exclusive Feature)

Capacity	Access Control Interface:	Communication
<ul style="list-style-type: none">G Faces 30,000 (1:N) 100,000(Optional)G Users / Cards 100,000 (Optional)G Transactions 1,000,000(Optional 2,000,000)User Photos 10,000Event Photos 7,500* Note: ProFace X with the optional 100,000 faces capacity, it does not support the following features: photo saving function, video intercom function	<ul style="list-style-type: none">Lock Relay OutputAlarm Output / Auxiliary InputExit Button / Door Sensor	<ul style="list-style-type: none">TCP/IPWiegand Input / OutputWi-Fi (Optional)RS485* / RS232*
Compatibility	Special Functions:	Additional Info
<ul style="list-style-type: none">Security Relay BoxWiegand / RS485 Slave Reader with FP / RFID / Barcode / QR-codeG Software: ZKBio CVSecurity	<ul style="list-style-type: none">G IP68 & IK04G 0.09s High Speed Face VerificationLive Face detectionCommunication Https Encrypted OptionalG Event SnapshotG Video Intercom : ZKTeco Private Protocol via TCP/IPSupport Devices: Standalone Terminal: Proface XIndoor Monitor: VT07-B01, VT07-B01-W	<ul style="list-style-type: none">G ZKFace 3.6Operating Temperature: -30°C ~ 60°C, (-22°F~ 140°F)Operating Humidity: ≤93%Storage Temperature: -40°C ~ +65°CStorage Humidity: ≤93%Net Weight: 853gDimensions (L*W*D): 227*143*26mm
Hardware	Standard Functions:	Power
<ul style="list-style-type: none">1.2GHz Quad Core Customized Computer Vision CPU1G RAM / 8G FlashG 8" (400lux) IPS Touch LCDID CardG IC CardMulti-Tech Card Module:G Module 1 : ID & IC & DESFire EV1 / EV2 & FelicaModule 2 : ID & IC & DESFire EV1/EV2 & FeliCa & HID Prox & HID iClass2MP WDR Low Light CameraHi-Fi VoiceMicrophoneDistance Detection SensorReset Button and Tamper Switch	<ul style="list-style-type: none">Standard SIP ProtocolSupport Devices: Standalone Terminal: Proface XIndoor Monitor: VT07-B22L, VT07-B26L-WSoftware: ZKBio CVSecurity, BioTalk ProMobile App: ZKBio ZexusONVIF Protocol (Compatible with Profile S, Profile T, Profile G, Profile C, Profile Q & Profile A)	<ul style="list-style-type: none">Operating Voltage 12V DCCurrent Draw < 2,000mA

* Note: RS232 is for external printer and RS485 is for RS485 readers.

Configuration

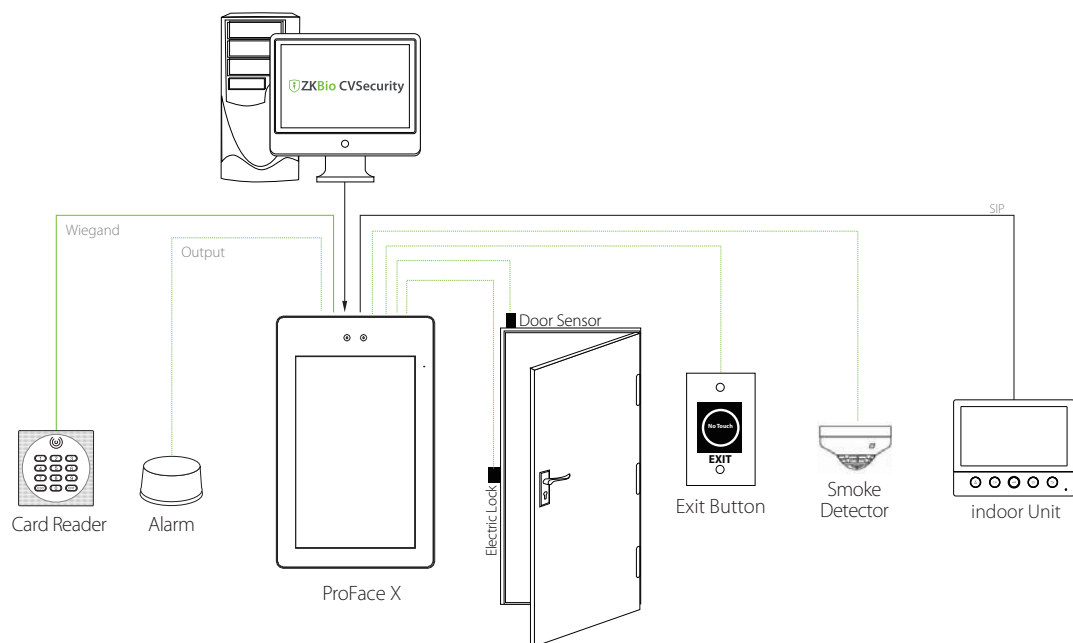

Dimensions (mm)

