

F34

Standalone Access Control Terminal Cloud Access Meets Video Intercom

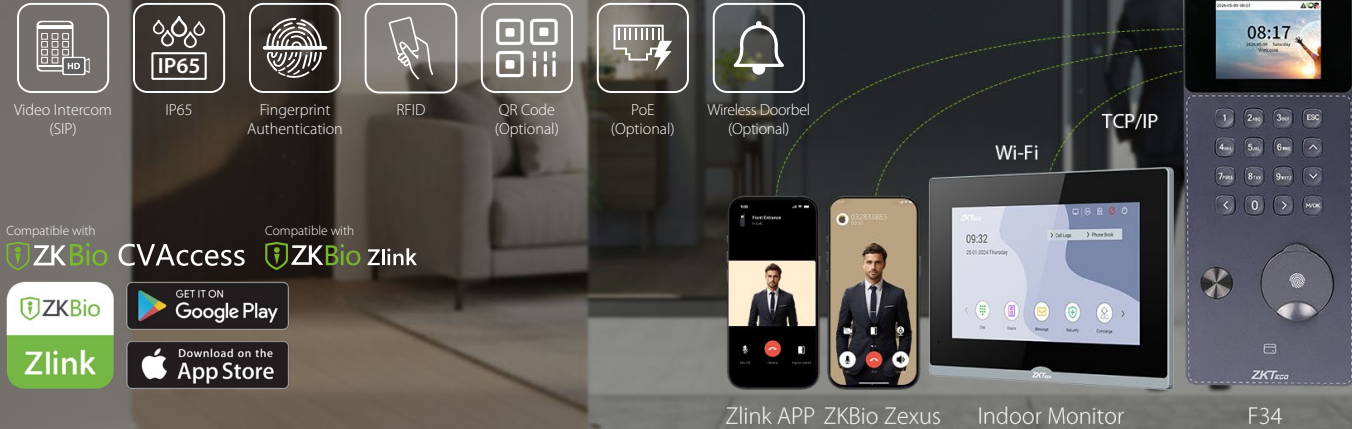

F34 is a standalone cloud-supported access control terminal with video intercom, designed for secure entry management. Key hardware includes a 2.4-inch TFT color display, 2 MP camera, built-in microphone, and speaker, and supports SIP-based intercom with an indoor monitor. F34 supports the ONVIF protocol; its firmware has BEST protocol by default to link with ZKBio Zlink (AC module) and can change to AC push or TA push, so that it is compatible with different AC or TA software.

With fingerprint, card, password and QR Code (optional) authentication, F34 offers versatile access options for different application needs. Powered by ZKFingerprint V13.0, it delivers fast and reliable verification, while its IP65-rated design and PoE support help ensure stable operation in demanding environments.

Features

- Multiple Verification Methods: card / password / fingerprint (authentication speed less than 0.5 second).
- It supports SIP 2.0 as the protocol for video intercom.
- Support Dynamic QR Code on ZKBio Zexus APP.
- Features TCP/IP and 4G (Optional), dual Wi-Fi modes: AP (broadcasts hotspot for app/laptop configuration without network) and client (joins existing Wi-Fi). Easy configuration.
- It supports multi-tech cards: 125 kHz ID (standard), 13.56 MHz IC (optional). It also supports DESFire EV1 / EV2 dual-frequency modules (optional) which fits mixed credential environments without deployment hassle.
- Default BEST Protocol supports or PUSH protocol by manual conversion.
- Optional PoE (IEEE 802.3at) reduces cabling and eliminates separate power adapters, minimizing installation costs.

* Power via PoE: When using PoE as the power source, use an electric mortise lock rated up to 12V / 0.85 A. Do not exceed this rating.
 * 4G SIM card (pending feature): For 4G operation, insert or replace the SIM card only when the device is powered off. Do not hot-swap the SIM card while the device is on.

Specification

Model	F34
Display	2.4"@TFT Color LCD Screen (240 x 320)
Camera	Video Intercom Camera @ 2MP, Field of View: Diagonal: 145°, Horizontal: 118°, Vertical: 62° QR Camera (Optional) @ 0.3MP, Field of View: Diagonal: 88°, Horizontal: 80°, Vertical: 60°
Operation System	Linux
Hardware	CPU: Dual Core@1.0GHz RAM: 512MB; ROM: 8GB Speaker: 8ohms±20% @1.0W Microphone: *1 (Sensitivity: -45 dB) Physical Keypad: 17 Keys Fingerprint Sensor: ZK Optical Sensor

Authentication Method	Fingerprint/ Card/ Password (Physical Keypad)/ QR Code (Optional)
Fingerprint Template Capacity	5,000 (1:N)
Card Capacity	5,000 (1:N)
User Capacity	5,000 (1:N)
Transaction Capacity	200,000
Max. User Password Length	6 - 8 digits
Biometric Authentication Speed	less than 0.5 sec (Fingerprint)
False Acceptance Rate (FAR) %	FAR≤ 0.0001% (Fingerprint ; ZKFingerprint V10.0; ZKFingerprint V13.0)
False Rejection Rate (FRR) %	FRR≤ 0.01% (Fingerprint ; ZKFingerprint V10.0; ZKFingerprint V13.0)
Biometric Algorithm	ZKFingerprint V13.0 (Standard) / V10.0 (Optional)
Card Type	ID Card@125 kHz (Standard) IC Card@13.56 MHz (Optional) Optional Multi-Tech Module: Module1: ID & IC & DESFire EV1/EV2; (125 kHz & 13.56 MHz Dual Frequency)
QR Code (Optional)	Dynamic QR codes on the ZKBio Zexus mobile application
Communication	TCP/IP*1 Wi-Fi (IEEE802.11b/g/n/ax) @ 2.4 GHz (Optional) Wiegand (Input or Output)*1 RS485: ZKTeco RS485*1 USB: Type A (USB Drive Only)*1 Aux Inputs *1, Electric Lock*1, Door Sensor*1, Exit Button*1, Alarm*1, 12V Output*1
Mobile Communication (Optional and Coming Soon)	TDD-LTE: B34 / B38 / B39 / B40 / B41 FDD-LTE: B1 / B2 / B3 / B4 / B5 / B7 / B8 / B12 / B13 / B14 / B17 / B18 / B19 / B20 / B25 / B26 /B28 /B66 /B71
Standard Functions	Webserver, ADMS, DST, Up to 14-digit User ID, Access Levels, Groups, Holidays, Anti-Passback, Record Query, Schedule Bell, Tamper Switch Alarm, Automatic Status Switch (Effective only under T&A rules), Multiple Verification Methods, SIP Client (Version 2.0), ONVIF (Compatible with Profile S, Profile T, Profile G, Profile C, Profile Q & Profile A), AC PUSH and TA PUSH Protocol Switch, HTTPS / SSH Backend Access, T9 Keyboard (Input), SRB
Optional Functions	Wi-Fi (AP Mode), PoE, Wireless Doorbell, QR Code
Access Control Interface	RS485 (RS485 Card Reader / Biometric Reader)
Power Supply	DC 12V 3A PoE: IEEE 802.3at (Optional)
Operating Temperature	-5°C to 45°C
Operating Humidity	10% to 90% RH (Non-condensing)
Dimensions	216 mm*82 mm*32.5 mm (L*W*H)
Gross Weight	0.72 Kg
Net Weight	0.51Kg
Supported Software	On-Premise Software: ZKBio CVAccess (AC PUSH) / ZKBio Time (TA PUSH) Cloud-based Software: ZKBio Zlink by default (Supports Web Portal & Mobile App)
Installation	Wall-mount (Compatible with Asian Gang Box / Single Gang Box), compatible with Rots-3 Stand / Rots-02 Bracket
Ingress Protection Rating	IP65 (waterproof and dustproof)
Certifications	ISO14001, ISO9001, CE, FCC, Equivalent to RoHS
Order ID	AC01-F34H-21

Configuration

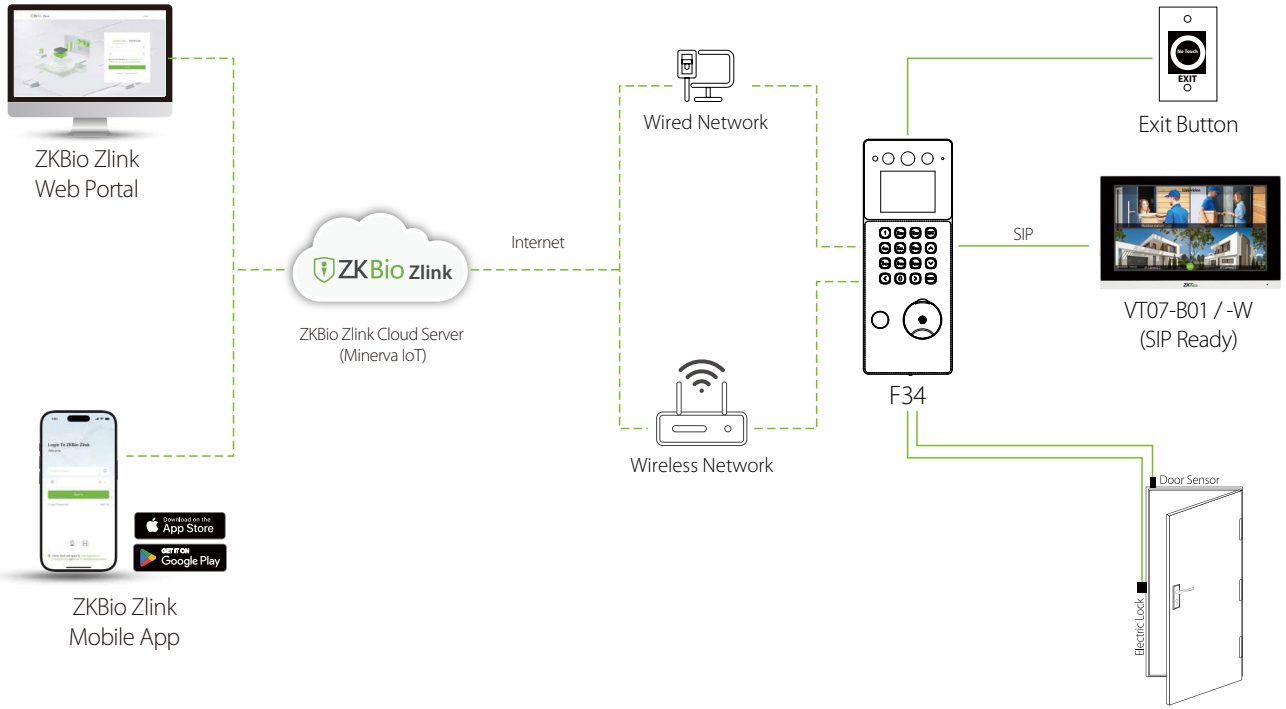

BEST Protocol

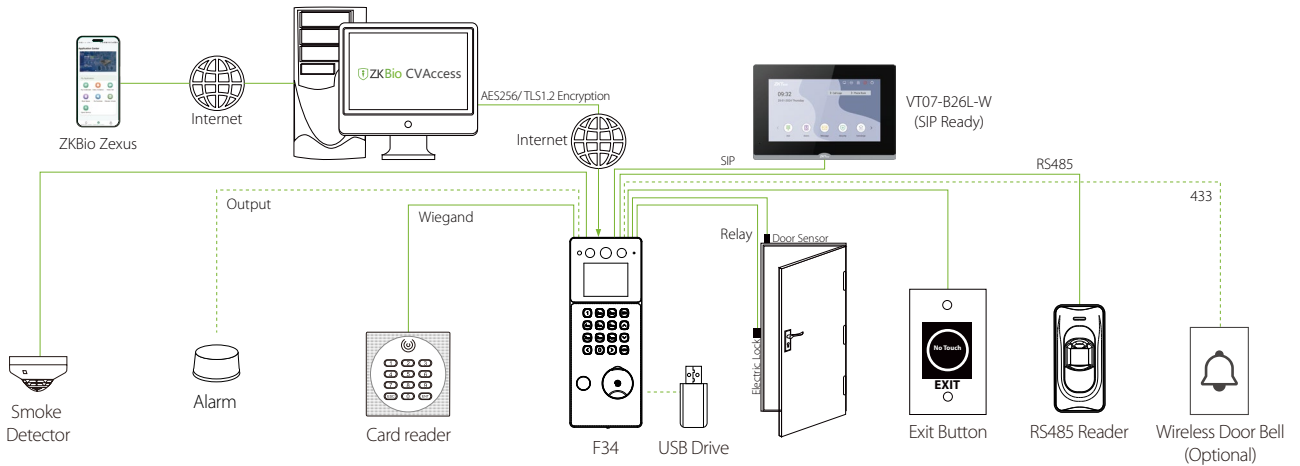

PUSH Protocol

Dimensions (mm)

